

Covering Schedule									
Id	Qty	Type	Start Length	Gage	OP	Fin.	Color	Increment	Direction
#34	3	PR	24'-1 3/8"	26	D	K	AG	9"	Left to Right From Peak
#35	10	PR	24'-1 3/8"	26	C	K	AG	9"	Right to Left From Peak
Oper. Code:D=SQ,RT									
Oper. Code:C=SQ,LF									
Finish:K=XXL									
Color:AG=Ash Gray									

Trim Schedule	
Id	Parts
T1	(2) HT14, HT10
T2	GAC1024, NLTA10, PURLIN CLOSURES
T3	(2) GAC1024, (3) NLTA10, PURLIN CLOSURES

Color	Details
Match Wall Color	
Match Wall Color	RC80A3
Match Wall Color	RC80A3

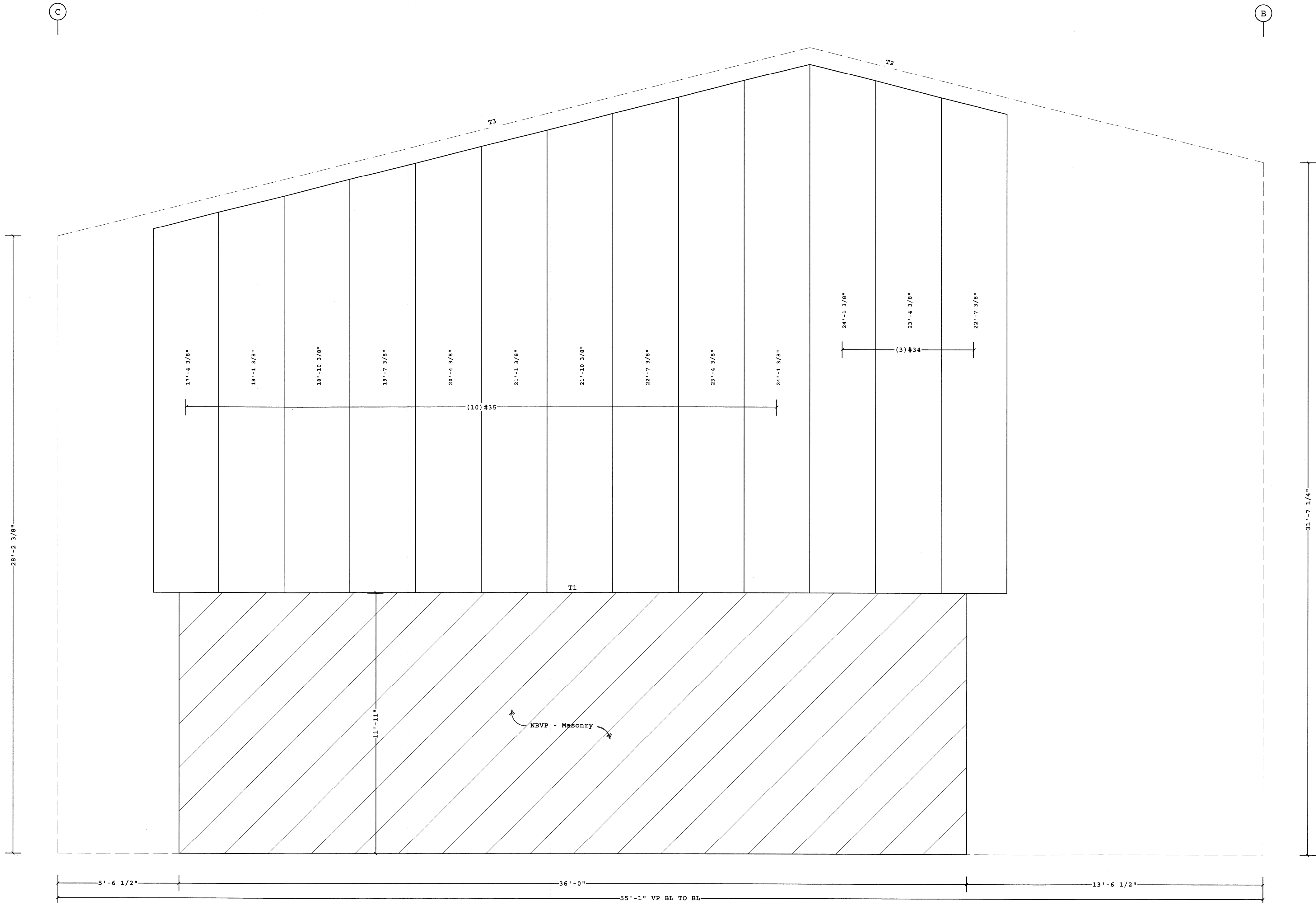

COVERING ELEVATION AT PARTITION OR MISC. 3

Shape Name = Shop & Parts Room, Wall = 3

FOR CONSTRUCTION

- PRE-DRILLING 1/8 DIAMETER HOLES FOR WALL STRUCTURAL FASTENERS MAY BE REQUIRED AT 11 GAGE GIRTS, NESTED GIRTS, GIRT LAP LOCATIONS, AND/OR SECONDARY STRUCTURAL BEAMS
- WALL SHEETS ARE AN INTEGRAL PART OF THE STRUCTURAL SYSTEM, REMOVAL OR ALTERATION WITHOUT PRIOR AUTHORIZATION IS PROHIBITED.
- PANELS SHOWN WITH A LENGTH LESS THAN 1-0, 5-0 FOR SSR, MAY HAVE TO BE FIELD CUT.
- SEE JOB DETAILS FOR SHEETING AND TRIM FASTENER SPECIFICATION.

THE VP ENGINEER'S SEAL APPLIES ONLY TO THE WORK PRODUCT OF VP AND DESIGN AND PERFORMANCE REQUIREMENTS SPECIFIED BY VP. THE VP ENGINEER'S SEAL DOES NOT APPLY TO THE PERFORMANCE OR DESIGN OF ANY OTHER PRODUCT OR COMPONENT FURNISHED BY VP EXCEPT TO ANY DESIGN OR PERFORMANCE REQUIREMENTS SPECIFIED BY VP.

THIS DRAWING, INCLUDING THE INFORMATION HEREON, REMAINS THE PROPERTY OF VP BUILDINGS. IT IS PROVIDED SOLELY FOR ERECTING THE BUILDING DESCRIBED IN THE APPLICABLE PURCHASE ORDER AND SHALL NOT BE MODIFIED, REPRODUCED OR USED FOR ANY OTHER PURPOSE WITHOUT PRIOR WRITTEN APPROVAL OF VP BUILDINGS.

THE GENERAL CONTRACTOR AND/OR ERECTOR IS SOLELY RESPONSIBLE FOR ACCURATE, GOOD QUALITY WORKMANSHIP IN ERECTING THIS BUILDING IN CONFORMANCE WITH THIS DRAWING, DETAILS REFERENCED IN THIS DRAWING, ALL APPLICABLE VP ERECTION GUIDES, AND INDUSTRY STANDARDS PERTAINING TO PROPER ERECTION, INCLUDING THE CORRECT USE OF TEMPORARY BRACING.

VP Buildings  
3200 Players Club Circle Memphis TN 38125

REV	DATE	BY	DESCRIPTION
NTS			

COVERING ELEVATION AT PARTITION OR MISC. 3

BUILDER	Broadmoor, LLC
CUSTOMER	Naval Air Station JRB
LOCATION	Belle Chasse, Louisiana
PROJECT	F-15 CIRF Upgrade
BUILDERS POF	



JOBNO	09-12315 EP1
DATE	15 OCT 09
DRAWN/CHECK	PCD
PAGE	96 OF 50

10/16/2009

7:37:44

FILENAME: 09-12315 EP1.VPC

a division of BlueScope Buildings North America, Inc.